

**Product Specification**

Model: PCLI18650-2S1P  
2900mAh 7.4V Lithium

Preliminary

ZEUS CONFIDENTIAL

**Amendment History**

Rev	Description	Date	Name
Pre	Initial draft	7-10-17	Kevin Oh

**Customer Approval**

Company Name	Department	Date	Signature

- **For Air Shipments** A 30% state of charge (SOC) limit on secondary lithium-ion cells and batteries, including Section II cells and batteries, will now apply. This does not apply to batteries packed with or contained in equipment (Effective April 1, 2016).
- Lithium cells/battery packs must be charged within 45 days of receipt to avoid over discharge.
- Shipping lithium materials must be done through a licensed shipper with appropriate packaging & labeling to meet current regulations.

These amendments are detailed in a lithium battery update document found on the International Air Transport Association (IATA) website: <http://www.iata.org/whatwedo/cargo/dgr/Documents/lithium-battery-update.pdf>

### 1. Scope

This specification applies to lithium ion battery supplied by Zeus Battery Products.

### 2. Model: PCLI18650-2S1P

Description: 7.4V 2900mAh Li-ion

### 3. Specification

No.	Items	Parameter	Remarks
1	Capacity	2900mAh	Discharge: @ 0.2C d discharge at room temp
2	Nominal Voltage	7.4V	
3	Max. continuous discharge current	3.0A	
4	Peak current	4.5A	Less than 3sec
5	Discharge cut-off Voltage	6.0V	3.0V/cell
6	Charge voltage	8.4±0.01V	
7	Max. charge current	2.6A	
8	Internal Resistance	≤150mΩ	
9	Operating temperature	Charge: 0 ~ 45°C Discharge: -20 ~ 60°C	
10	Weight	Approx. 100g	
11	Cycle Life	≥500	@ 0.2C discharge at room temp
12	Storage temperature	-10 ~ 40°C	15~25°C recommended for long-term storage

**3. Battery Pack Dimension**  
(unit: mm)

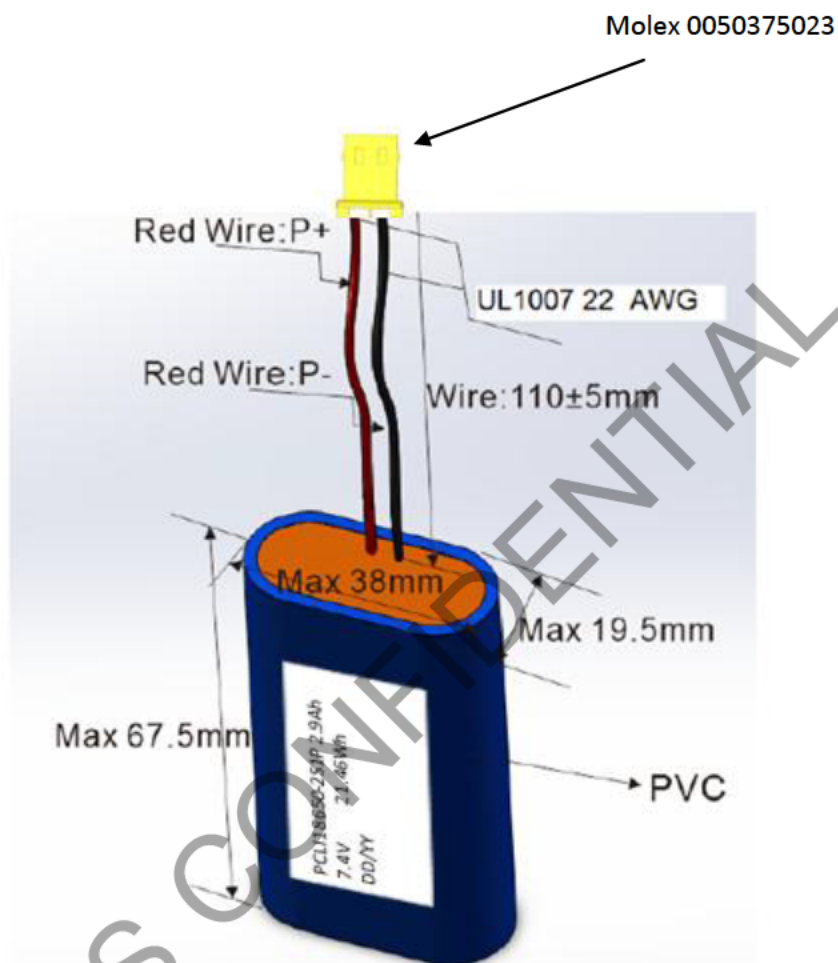

Pin Assignment  
Pin1: Red (+)  
Pin2: Black (-)

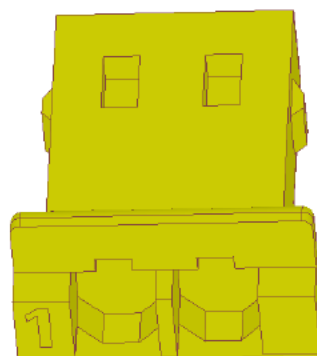

#### 4. Battery Handling Precautions

- ◆ Don't immerse battery in water or allow it to get wet!
- ◆ Don't charge, use and store battery near a heat source such as fire heater! If the battery leaks or releases strange odor, please remove from heat source immediately. Fully charge the battery before first-time use
- ◆ Don't reverse the positive and negative pole of battery!
- ◆ Don't throw the battery into fire or heat it!
- ◆ Don't short-circuit battery with wire or other metal objects!
- ◆ Don't disassemble the battery in any way!
- ◆ Don't put the battery into microwave oven or pressure vessel!
- ◆ If the battery gives off odor, gets heat, deformation, discoloration or appears abnormal behaviors, stop using it. Please remove the battery from electrical appliances and stop using it if the battery is being used or charged!
- ◆ Don't use battery in a very hot environment such as under direct sunlight or in car on hot day. Otherwise, the battery will overheat which will affect battery performance and shorten battery life!
- ◆ If the battery leaks and electrolyte leakage enters into the eyes, don't rub. Rinse with water immediately and seek medical assistance.
- ◆ Ambient temperature will affect the discharge capacity of battery, if the ambient temperature is beyond the standard environment ( $23\pm 2^{\circ}\text{C}$ ), the discharge capacity will be affected.

#### 5. Warranty

Products supplied by Zeus Battery Products contain 12 months warranty against manufacturing defects. Any damage resulting either from user misuse or abuse will void the warranty.

*Note: This product specification is subject to change without prior notice.*